



Luxury Vinyl Series | Luxury Studio Series | Dryback Vinyl Series | Dryback 2.0 Series

Pre-installation Instructions	2
Installation Instructions	10
Care and Maintenance	12
Product Warranty	14



170-6333 Graybar Rd
Richmond BC, Canada



Tel: 604 276 0833
Fax: 604 276 0633
Toll Free: 1 888 540 0833



info@unifloor.ca
www.unifloor.ca
www.ecpremiumflooring.com

Responsibility of Homeowners and Installers:

- **It is important and mandatory that all installers carefully read the installation instructions in full before commencing any installation.**
- **Installation must not proceed if any part of the instructions is unclear, misunderstood, or unsatisfactory.**
- It is the homeowner's responsibility to thoroughly review and fully comply with all applicable maintenance and warranty documentation following installation and throughout the product's lifespan.
- A visual inspection of multiple boards must be conducted—by opening several boxes—with the homeowner or project manager to confirm that the product matches the ordered specifications in color, pattern, size, and texture is highly recommended before commencing installation.
- All materials must be thoroughly inspected throughout the installation process for any surface defects, including but not limited to damage, scratches, sheen variations, beveled edge paint spills, and other visible imperfections.
- Do not proceed with installation if the product's color or quality is deemed unsatisfactory. Once installation has begun, the product is considered accepted by the homeowner—even if they are not present. It is the installer's responsibility to ensure clear communication with the homeowner throughout the inspection process.
- All EC Premium - AquaFix products are manufactured to meet practical industry standards with a maximum of 5% defects as milling tolerance. Throughout the entire installation, any pieces of flooring that appear to contain a manufacturing defect should not be installed.
- It is the responsibility of the installer and homeowner to ensure all job site condition requirements are reached before commencing installation. Manufacture takes no responsibility for defects caused by improper job site preparation and installation procedures.
- Conduct a dry lay and present it to the designer/homeowner for approval before installation. Changing the direction of planks or tiles can create a more natural, varied look, but may also result in visible differences in gloss levels. This is not a defect, but a design preference. Be sure to review the layout under low sidelight conditions and proceed only after receiving final approval from the designer/homeowner.
- Performing and documenting all required pre-installation tests and verifying site conditions are mandatory prior to installation.
- Always verify the adhesive's expiration date before use. A bond test must be conducted prior to any installation, with both photo and video documentation properly recorded and retained.

Do not install any defective or unsatisfactory planks. EC Premium - AquaFix accepts no responsibility for any costs related to the installation of an unsatisfactory product.



170-6333 Graybar Rd
Richmond BC, Canada



Tel: 604 276 0833
Fax: 604 276 0633
Toll Free: 1 888 540 0833



info@unifloor.ca
www.unifloor.ca

Part 1 Pre-installation

A: INSTALLATION TOOLS

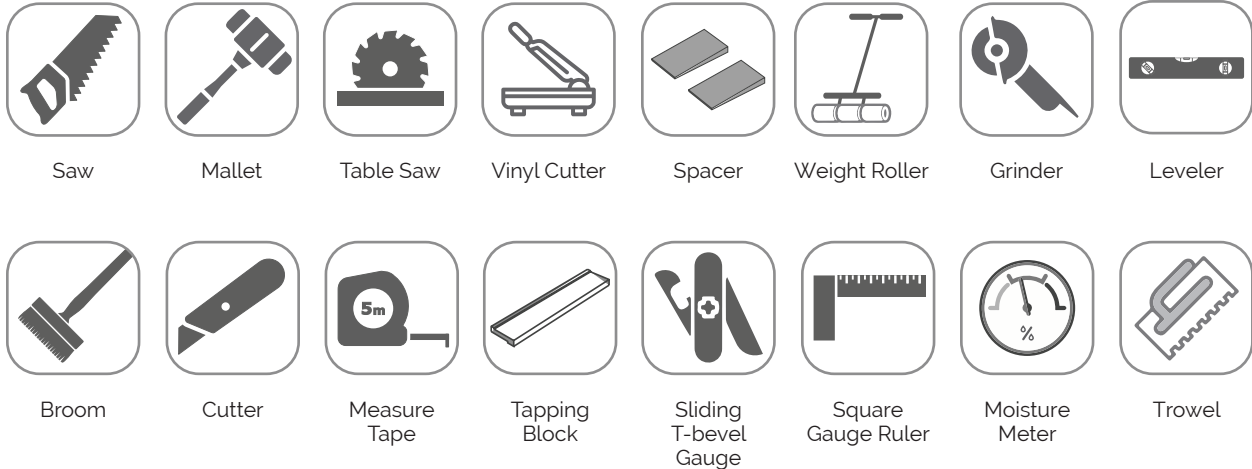

B: STORAGE

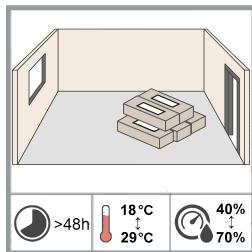

- **Delivery**
 - Please do not deliver flooring to the job site if the job site's climate conditions have not been met, as described in section E.
 - During transportation, all packages must be well protected from the weather.
 - Always transport Aquafix Vinyl in a flat position.
- **Storage before installation**
 - Panels should be stored unopened in the middle of the room at a room temperature of 18°C-29°C and relative humidity of 40%-70% for min. 48 hours.
 - Never store boxes on their sides or ends.
 - Avoid direct sunlight exposure.

C: APPLICATION

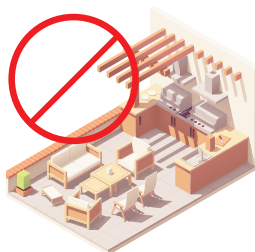

- EC Premium - AquaFix products are intended for indoor use as flooring cover only.
- EC Premium - AquaFix products are not suitable for use in garages, commercial kitchens, industrial food preparation areas, heavy industrial facilities, warehouses, or any areas where spiked footwear may be worn. For further guidance, please contact our Technical Support at Toll-Free: 1-888-540-0833.
- UV Glass or window coverings should be in place to prevent excessive heat build-up on the floor.

- All installation areas must be fully enclosed and weather-tight, with the permanent HVAC system actively operating at the time of installation and thereafter.
- **Only the full-spread glue-down installation method is approved** for all applications. Use approved adhesive only. Refer to Part 1, Section O for approved adhesives.

D: SUBFLOOR CONDITIONS

- **Subfloors & pre-existing flooring**
 - AquaFix vinyl products can be installed over concrete, OSB, plywood.
 - For radiant heating systems, see details in section G.
 - If installing over pre-existing hard surface flooring, ensure the entire layer of pre-existing flooring is fully adhered to the subfloor structure.
 - Carpet, carpet tile, or any cushioning material is not approved as pre-existing hard surface flooring.
 - When installing over tile or marble, all grout lines, cracks, and gaps must be filled with patching compound up to a smooth level; wait until compounds are completely dry and fully adhered to the substrate. Primer might be needed to ensure a strong bond.

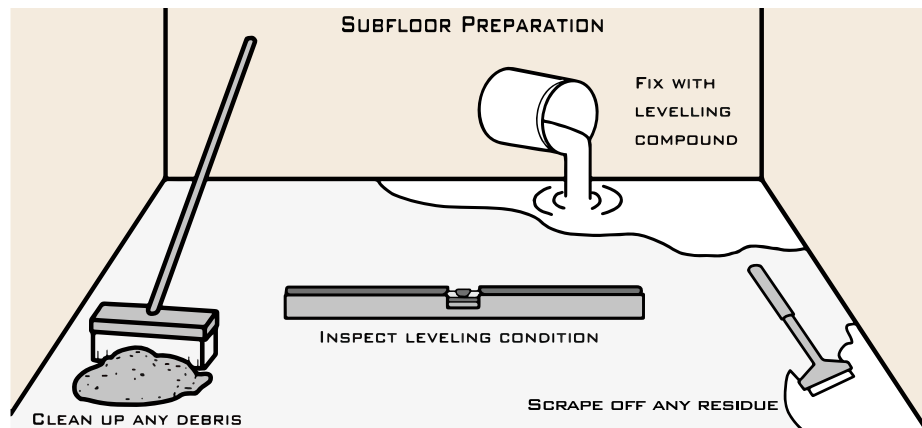

- **Evenness**

The subfloor must be levelled within the following parameters:

 - Maximum +/- 0.1" per 6.6' (2.5mm per 2m) radius span.
 - Maximum +/- 3/16" per 10' (4.7mm per 3m) radius span.
 - Grind down any irregularities and fill any uneven spots with the NWFA approved leveling compound.
 - No crack is allowed throughout the entire substrate.
 - Maximum deflection should be no more than 1.1mm (3/64").

- **Cleanliness**

The subfloor must be cleaned before installing all types of AquaFix vinyl flooring and free of any debris or microorganisms.

- **The following tests must be performed, and site conditions must be met and documented prior to installation:**

- ○ **Installation on concrete:**

- Compressive strength rated 3500 psi or higher.
- The moisture vapor emission rate should not exceed 2.27kg/92.9 sqm (5 lb/1000 sq. ft) per 24 hours, as per ASTM F1869.
- ASTM F2170 test method can also be used; internal relative humidity must be below 80%, and pH value between 7 and 9.
- Before installation, the entire concrete substrate must be completely cured and dry for at least 60 days.
- Adhere to all provisions outlined in the latest edition of ASTM F710, *Standard Practice for Preparing Concrete Floors to Receive Resilient Flooring*

- ○ **Installation on wooden subfloors:**

- Plywood subfloor moisture content must not exceed 12%, and the variance in moisture content between the subfloor and the flooring panels must not exceed 3.5%.
- In Canada, it is required to use a minimum of 5/8" (15mm) tongue and groove (T&G) plywood or 3/4" (19mm) T&G OSB for subflooring.
- The subfloor panels must be securely attached to the joists, free of squeaks, bounces, with maximum deflection of 1.1mm or 3/64".
- The wooden substrate must not be treated with any substances such as preservatives or moisture inhibitors, and must be completely free of wax, silicone, solvents, dyes, or any other materials that could potentially stain the flooring

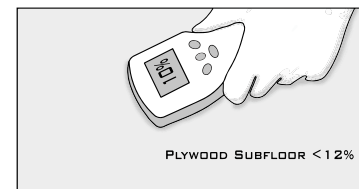

⚠ The manufacturer, distributor, or dealer shall not be held liable for any installation failures arising from unaddressed site conditions, including but not limited to vapor transmission, moisture intrusion, elevated or imbalanced pH levels, contaminated concrete, or compromised subfloor integrity.

E: TEMPERATURE AND MOISTURE CONDITIONS

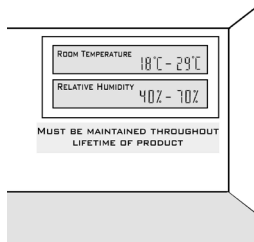

- It is also essential that the flooring material is in the same temperature range as the installation site. As described below, do not deliver flooring to job sites if climate conditions have not been met.
- Allow the flooring to acclimate at the climate-controlled job site for a minimum of **48 hours** when the desired climate range has been met.
- The room temperature should be **18°C (65°F) - 29°C (85°F)**. With ambient air relative humidity is between **40%-70%**. These environmental conditions must be maintained for the life of the product (before, during, and after the installation).
- HVAC system must be fully operating in all areas.
- UV-protective glass or window coverings must be installed prior to flooring installation to prevent excessive heat build up.

F: SPACE FOR EXPANSION & MAXIMUM SIZE WITHOUT EXPANSION GAP

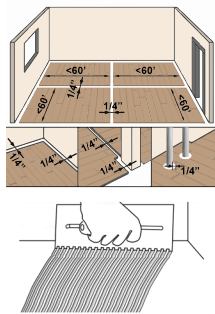

- During installation, leave a 3/8" (or 1/2" for rooms over 2000sf) expansion space around the entire perimeter of the floor between the flooring and the walls and all vertical/fixed objects (e.g., door structures, fireplace, tiles, cabinets, kitchen island, and so on). Undercutting vertical structures might be an option by ensuring no damage to the structural function of the objects.

G: INSTALLATION OVER A RADIANT HEAT SYSTEM

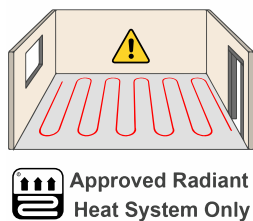

- AquaFix - Luxury Vinyl Series can be installed over the hydronic and electric radiant heat system. Both hydronic pipes and heating wires must be embedded and isolated with a minimum of 3/8" (9.5mm) thick concrete or plywood.
- Ensure that the system is in complete working order and has been thoroughly tested and running for a minimum of two weeks before installation. The system should be turned off 24 hours before installation in the install zone.
- During installation, the temperature should maintain at 18°C (65°F) - 29°C (85°F). **Never allow the surface temperature of flooring to go above 29°C (85°F).**
- In increments, constantly adjust the temperature control from 4°C to 6°C gradually. Any dramatic temperature will cause damage to flooring.
- **AquaFix 2.5mm Dryback Vinyl Series and Dryback 2.0 Series are not suitable for installation over hydronic or electrical heat systems.**

H: PRODUCT INSPECTION

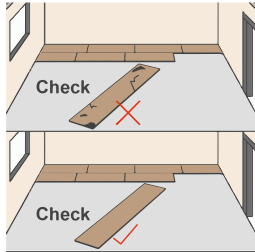

When racking, inspect all boards for visible manufacturing defects. Under the product warranty terms, the dealer may replace boards with manufacturing defects in excess of industry standards (5% of total quantity). **Once installed, boards will be considered accepted by the homeowner, even if the homeowner is not present during installation.** Supplier accepts no responsibility for problems arising from this improper handling.

I: PANEL MIXING

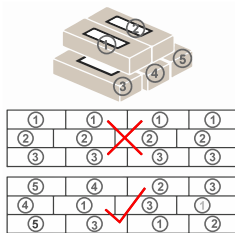

- Prepare at least four flooring packs and mix panels from different boxes during installation.
- We recommend the alternate fitting of the panels from four different packs simultaneously.
- Keep alternating the panels across the entire floor area. It guarantees the best possible appearance of your flooring product.

J: USE OF MASKING TAPES

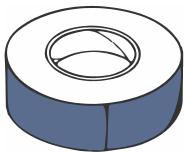

3M Scotch Blue Tape

Only 3M scotch blue tape is allowed for all installation methods.

K: STAGGER PATTERNS

- Stagger short end (butt joints) with a minimum of 15.75" (40cm) for the adjacent two rows.
- Avoid using boards less than 10" (25.4cm).
- Avoid 'H' style, stair-step style in any adjacent rows.

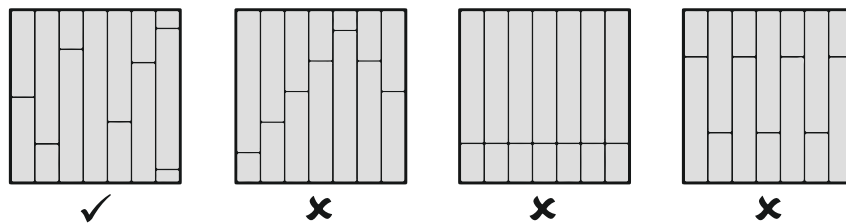

L: LAYING DIRECTION

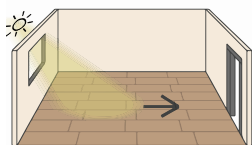

- The recommended installation direction is lengthwise to the primary light source.
- The joints are more visible crosswise than lengthwise to the light source.
- It is only a recommendation because there are also other influences.
- Avoid placing short-end joints over seams of the wooden subfloor.
- **The laying direction to be perpendicular to the subfloor joists is recommended.**



M: UNDERLAYMENT REQUIREMENT & LAYING

- **Wooden Panel Underlayment:**

The moisture content should not exceed 15%.

All panels must be smooth, free of dust, silicone, grease, or any other substances that may hinder proper bonding strength to the subfloor and new flooring covering.

All panels must have a minimum thickness of ¼" (6mm) and should be securely fastened using nails, fasteners, or subfloor adhesive, ensuring minimal structural deflection (no more than 1.1mm or 3/64").

- **Acoustical Underlayment:**

The use of acoustical underlayments is strongly **NOT ACCEPTED** for both the **Dry Back** and **Luxury Vinyl** series products.

Depressions resulting from heavy static or dynamic loads/weights can lead to uneven flatness between flooring planks.

N: TRANSITION MOULDING

- Please find your flooring products and download the coordinating transitions' profile image and installation guidance from www.unifloor.ca.

O: ADHESIVE

For All Applications:

- **Full-spread glue-down installation is mandatory** for all flooring applications.
- **Semi-wet set glue-down method is required** for all standard or typical environments.
- In settings with **extreme temperatures, heavy point loads, frequent topical moisture, or intensive maintenance routines**, a **2-component adhesive**—such as **Uzin MK 480**—**must be used** to ensure proper bond strength and long-term performance.

Mandatory Adhesives:

Only the following adhesives are approved for use in compliance with this installation system:

- TakTik 99 (Manufactured by Uzin)
- Uzin KE 2000S
- Stix 2400

P: BOND TEST

- 72 hour bond test must be performed before installation.
- Ensure that all subfloor conditions, pre-installation floor preparation, and environmental requirements are fully met and properly documented prior to installation.
- No Asbestos allowed.



[illegible]

Part 2 Installation - GLUE DOWN INSTALLATION

(For 5mm Luxury Vinyl Series products: mandatory for all commercial applications, and recommended for residential applications)

(For 2.5mm Dryback Vinyl Series products: mandatory for both commercial and residential applications.)

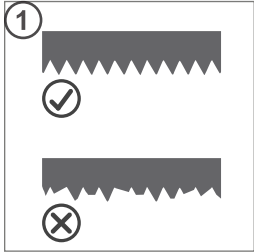

Trowel used:

- Use a metal trowel only.
- Use trowel styles recommended by adhesive manufacturers only.
- Replace any trowel that has worn teeth.

**Only professional hardwood flooring installers should be performing glue-down installations.

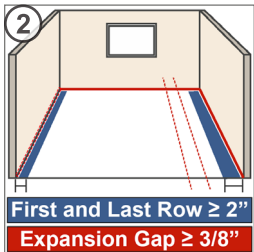

Starting your installation

Chose a starter point to set the starting row. (Refer to Part 1 – section K for laying direction guidance.) The main exterior wall should be used as a reference wall to start.

Set two chalk line reference points by measuring the same distance from each end of the reference wall, then snap your chalk line. Distance between the two chalk lines should equal the width of two planks.

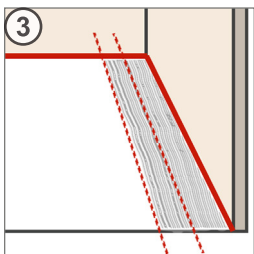

Start spreading adhesive to the subfloor along the chalk line but not to cover it.

Whether the job uses transitional pressure-sensitive or permanent firm set type of adhesive, always read and follow the adhesive manufacturer's instructions.

For areas where quick boards replacement might desire, pressure-sensitive type adhesive is preferable, be aware of the adhesive's open time, and follow their manufacturer's wait time before laying planks.

For areas with high traffic and intense loads/usage, the permanent firm set wet lay adhesive is mandatory.

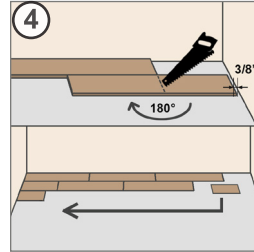
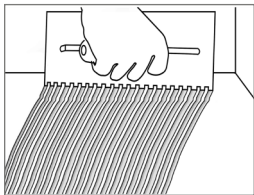

Lay down the first row of boards along the chalk line and continue with the second row of boards.

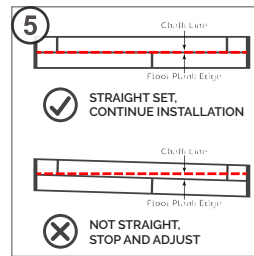

After the first two rows of boards are set, the alignment procedure must be done using a straight laser line or chalk line to ensure the starting rows are perfectly straight and parallel to the reference wall.

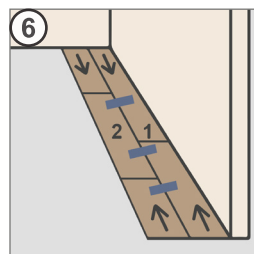

Then use approved adhesive tapes (3M scotch blue) to secure the joints of the boards and place the starting rows.

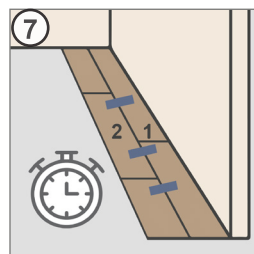

According to the adhesive manufacturer's recommendations, it is recommended to leave the first two starting rows enough cure time and get the adhesive fully cured before continuing to the next row.



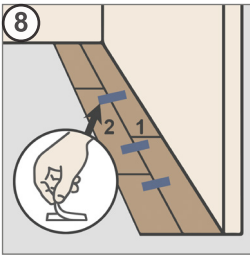

Remove adhesive tapes within 24 hours and peel off tape in a 45-degrees slow manner.



Always have your adhesive remover and damp dry cloth ready. Any excess adhesive left on the flooring surface or hands of the installer must be removed with the proper solvent recommended by the adhesive manufacturer.

Do not use the following products to remove adhesive on your floors:

- detergent;
- solvent-based polishes;
- soaps;
- citrus-based cleaner.

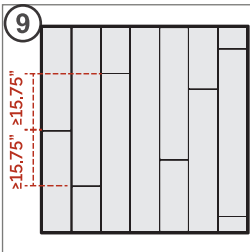

As installation continues, when placing the second row and every subsequent row, make sure to stagger the end joints a minimum of 15.75" (40 cm) apart from the previous row. (refer to Part 1, section K)

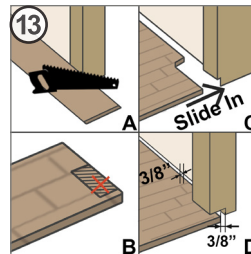

Maintain proper expansion space (refer to Part 1, section F).

Installation towards door frames

Lay a panel next to the door frame (with the patterned side facing downwards) and cut into the door frame with the straight backsaw. Then slide the panel under the frame with the patterned side upwards. Don't forget to allow for freedom of movement here to 3/8" (10 mm).

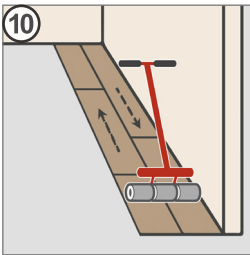

Using a weighted floor roller, ensure that every plank is pressed and firmly attached to the adhesive. The rolling action will also remove any trapped air between the floor and substrate.

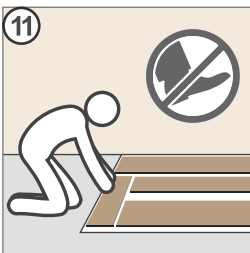

Avoid working directly on top of newly installed areas.



Wait for a minimum of 24 hours before moving furniture onto the floor.

⚠ In bathrooms and other areas prone to moisture exposure at the perimeter, apply 100% silicone caulk around the edges of the installation to prevent water from reaching the subfloor. Ensure that the caulk does not extend above the finished floor height, as this may interfere with the proper installation of wall base or trim.

⚠ Do not wet mop the floor or apply any stripping agents for a minimum of seven (7) days following installation, to allow adequate curing time for the adhesive. During this period, only a damp mop may be used to gently remove surface dust



170-6333 Graybar Rd
Richmond BC, Canada



Tel: 604 276 0833
Fax: 604 276 0633
Toll Free: 1 888 540 0833



info@unifloor.ca
www.unifloor.ca

Part 3 Care and Maintenance

A: CLEANING

- Under no circumstances should the floor be soaked with liquid. LVP and Dryback Vinyl flooring are waterproof themselves; excessive moisture will grow microorganisms, which will cause damage to the flooring's structure.
- Sweep the floor regularly to keep it free of dust, grit, and other abrasive materials.
- Sweep the floor with a damp cloth along with the recommended cleaner. (e.g., Bona vinyl cleaner) Apply cleanser to the cloth, not directly on the floor.
- Hardened glue-residue can be removed with acetone or a special glue solvent, or may use usual household cleaners; please avoid scouring agents, wax, polish, and bleach.
- For regular cleaning and preservation, we recommend Bona Vinyl Flooring Cleaner. Larger soiling and persistent stains like color, glue, nail varnish, or oil can easily be removed using acetone or other alcohol-containing solvents. (Must be approved to be used for vinyl flooring according to NWFA guidelines.)
- If a vacuum is used, make sure a soft texture nozzle is attached to avoid scratch marks being left on the surface.

B: PROTECTION

- To prevent damage from heavy static loads—such as hospital beds, pianos, refrigerators—or from heavy dynamic (rolling) loads, it is recommended to use devices and rollers/casters that evenly distribute weight. It is the responsibility of the furniture, appliance, or equipment manufacturer to ensure their products are suitable for use over the flooring and to address any damage resulting from their use. AquaFix flooring is warranted only against wear under normal use conditions. The manufacturer and distributor do not cover any form of physical damage caused by the scenarios described above.
- All AquaFix products carry **no responsibility or warranty** for any physical damage caused by external forces, such as dynamite or static loads. This includes, but is not limited to, physical dents, scratch marks, and similar damage.
- All AquaFix vinyl flooring must be protected from direct sunlight exposure. UV protective film, blinds, or curtains must be used in all windows that provide direct sunlight to ensure that the products are not overheated.
- Use a heavy-duty floor protection membrane (e.g., Floor Guard with heavy-duty floor protection) to cover all areas until no other contractors work within the job site.
- Avoid taping the protection membrane directly to the floor's surface by overlapping each run of the membrane while taping different runs together.
- Tape the end run of the membrane along the baseboard or shoe base with extremely low adhesive tape.
- An extra layer of plywood, MDF board, might be used along the hallway or high traffic areas where furniture and appliances will be transferred into the premises.
- Putting felt pads on all furniture's legs is highly recommended.

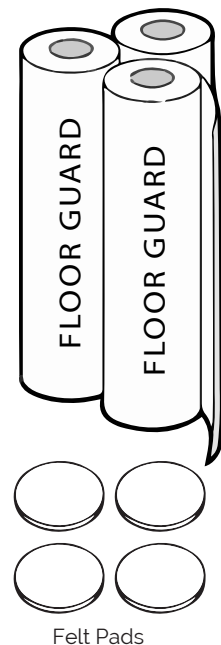

- ## C: MAINTENANCE

- NOTES:**

This image shows a full page of handwriting practice paper. It contains ten identical rows of horizontal guidelines. Each row is composed of three lines: a solid top line, a dashed middle line, and a solid bottom line. The rows are evenly spaced across the entire page, providing ample space for practicing letter formation and alignment. There is no text or other markings on the page.

Part 4 Product Warranty

A: LIMITED RESIDENTIAL WEAR WARRANTY

- EC Premium - AquaFix warrants that the decor layer underneath the top wear layer will not wear through under normal residential traffic and effective from the purchase date.

LVP Series	DryBack Series	DryBack 2.0 Series
30 YEARS	30 YEARS	25 YEARS

B: LIMITED COMMERCIAL WEAR WARRANTY

	Light Commercial
LVP Series	15 YEARS
DryBack Series	15 YEARS
DryBack 2.0 Series	10 YEARS

- EC Premium - AquaFix warrants that the decor layer underneath the top wear layer will not wear through in the light commercial application. (e.g. salon, clinic, or boutique).
- Food court, supermarket, industrial zone, or entrance, the hallway of business office considers a high traffic commercial application.

C: WARRANTY DISCLAIMER - MANUFACTURING AND VISUAL DEFECTS

- The manufacturer/distributor warrants that its flooring products shall be free from manufacturing and visual defects. In the event such defects are identified, the uninstalled and defective product must be returned to the original place of purchase to be eligible for a full credit.
- Under no circumstances shall the manufacturer/distributor be held liable for any costs, claims, or damages arising from the installation of flooring known to be defective at the time of installation.
- Any product that has been installed shall be deemed to have been inspected and accepted by the installer and/or end user, and as such shall not be eligible for replacement, refund, or any other form of compensation.
- This limited warranty applies solely to finish-related defects and shall be enforceable only when the defective material exceeds five percent (5%) of the total square footage of the flooring purchased.

D: FILING A CLAIM

- Copy of the original purchase receipt must be submitted to the original dealer.
- Coordinate with inspection appointments set by dealer and distribution.
- A minimum of five full planks must be kept for testing purposes.
- EC Premium - AquaFix only accepts claims of defective products, with over 10% of the total quantity of products during the warranty covered period. Customers can claim the same quantity as defect quantity with the same or similar products. But, in case a specific product has been discontinued, a similar product or portion of the original purchase value, which is equivalent to the defect quantity, can be refunded to the original purchaser.
- In the event of a claim, the manufacturer and distributor expressly reserve the right to conduct an on-site inspection of the affected flooring prior to the commencement of any repair or replacement work. Claims must be formally submitted to and approved by Unifloor in writing before any corrective action is taken. Failure to comply with this requirement shall render the warranty null and void. Under no circumstances will Metropolitan be responsible for labor costs associated with the removal or installation of flooring materials.



E: WARRANTY EXCLUSIONS

- All installations must be performed following the EC Premium - AquaFix installation manual.
- Proper care and maintenance must be performed under the EC Premium - AquaFix maintenance instructions.
- The surface sheen reduction is a natural aging of products and is not considered a defect of surface wear.
- Any damage caused by chemical spills, water leakage, surface scratches, cutting, fire, high-heel shoe marks, scuffing, squeaking, chipping, excess dryness, moisture, or abuse of any kind is not covered by warranty.
- Dents or other damage caused by rolling or moving excessively heavy items or loads across the floor.
- Damage from subfloor leveling, squeaks, bounce, deflections exceeding 1.1mm or 3/64".
- Labour cost is not covered by this warranty.
- EC Premium - AquaFix is not responsible for the expansion and contraction of panels due to any improper temperature or moisture control, direct sunlight exposures, and overheating by electronic devices.
- EC Premium - AquaFix accepts no responsibility for any problems arising from pets, insects, or microorganisms.
- All AquaFix products carry **no responsibility or warranty** for any physical damage caused by external forces, such as dynamite or static loads. This includes, but is not limited to, physical dents, scratch marks, and similar damage.
- All surface wear on transitions or stair nosings is not covered by this warranty.
- Installation of products that are not compliant with radiant heat will void the warranty.
- The products' warranty is not transferable and is limited to the original purchaser only.
- Under flooring industry standards, 5% of industrial defects out of the total quantity of products is allowed. As a result, 10% of wastage during any installation should be calculated before installation is performed.
- Any defective piece found before installation should not be installed; once products are installed, they will be deemed to have been accepted by the customer. It is the responsibility of the installer and the homeowner to inspect products defects before installation. EC Premium - AquaFix accepts no liability for any labour cost or related expenses incurred to replace the product that has been installed with evident and visible defects.
- Excessive wear caused by subfloor telegraph/unevenness, deflections are not covered by this warranty.
- The British Columbia provincial law governs this Limited Warranty set above. EC Premium - AquaFix assumes no liability for incidental or consequential damages arising from the product's use or non-use.
- Products sold as is; auction goods, discontinued/off the rack, or indirect trades by unauthorized dealer/individual are not covered by the manufacturer warranty.
- Failure of providing the original purchasing invoice from Unifloor Trading Inc. will void warranty.
- Under no circumstances will the value of a warranty claim exceed the original purchase price of the product.

There are no other extended warranties except statements set above.



170-6333 Graybar Rd
Richmond BC, Canada



Tel: 604 276 0833
Fax: 604 276 0633
Toll Free: 1 888 540 0833



info@unifloor.ca
www.unifloor.ca



www.unifloor.ca